

TWIN POWER 2500MgS 02

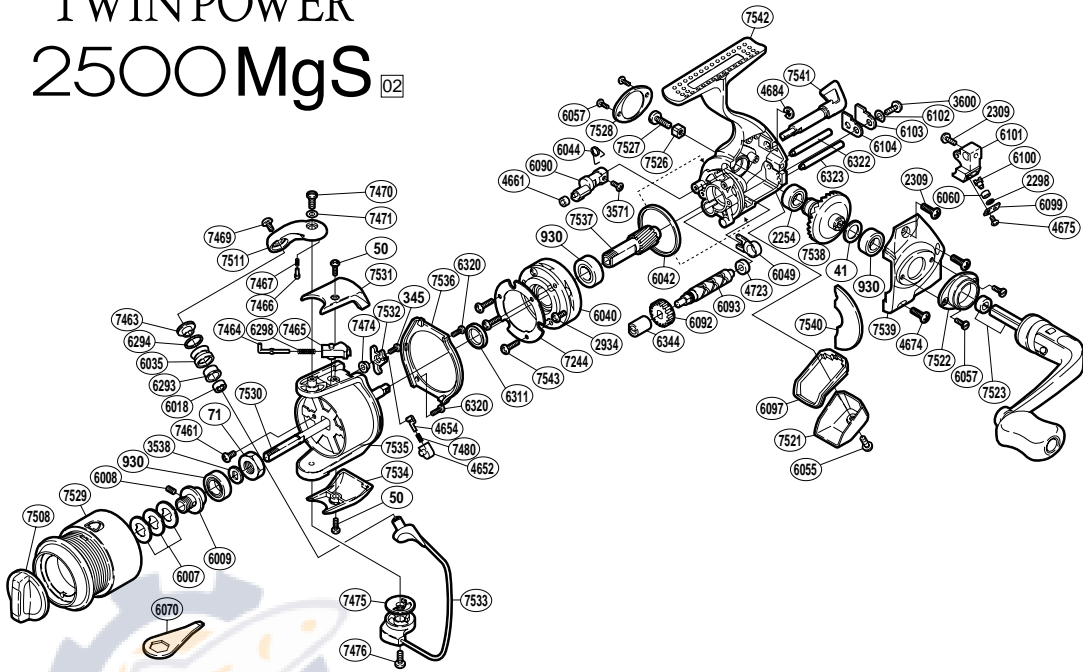

RD No.	PARTS NAMES	RD No.	PARTS NAMES	RD No.	PARTS NAMES
0041	Drive Gear Washer	6060	Oscillating Slider Bushing	7471	Bail Arm Screw Washer
0050	Multi-Purpose Screw	6070	Wrench (accessory)	7474	Bail Trip Lever Washer
0071	Rotor Nut	6090	Anti-Reverse Cam	7475	Bail Hold Support Spacer
0345	Bail Trip Lever Screw	6092	Idle Gear	7476	Bail Hold Support Screw
0930	Ball Bearing	6093	Worm Shaft	7480	Lever Spring
2254	Ball Bearing	6097	Rear Shield	7508	Drag Knob
2298	Spacer	6099	Oscillating Pawl Cover	7511	Bail Arm
2309	Multi-Purpose Screw	6100	Oscillating Pawl	7521	Rear Protector
2934	Clutch Cover Screw	6101	Oscillating Slider	7522	Handle Screw Cap (A)
3538	Spool Support	6102	Worm Shaft Retainer Spacer	7523	Handle Assembly
3571	Anti-Reverse Cam Screw	6103	Worm Shaft Retainer	7526	Handle Lock Washer
3600	Worm Shaft Retainer Screw	6104	Worm Shaft Retainer Washer	7527	Handle Lock Screw
4652	Lever Spring Guide (B)	6293	Line Roller Bushing	7528	Handle Screw Cap (B)
4654	Lever Spring Guide (A)	6294	Line Roller Spacer	7529	Spool Assembly
4661	Anti-Reverse Cam Ring	6298	Bail Spring	7530	Main Shaft
4674	Side Cover Screw	6311	Rotor Spacer	7531	Bail Spring Cover
4675	Oscillating Pawl Cover Screw	6320	Rotor Guard Screw	7532	Bail Trip Lever
4684	"E" Lock	6322	Oscillating Guide (A)	7533	Bail Assembly
4723	Worm Bushing (rear)	6323	Oscillating Guide (B)	7534	Bail Hold Support Guard
6007	Spool Washer	6342	Roller Clutch Screw	7535	Rotor
6008	Set Screw	6344	Worm Bushing (front)	7536	Rotor Guard
6009	Bearing Bushing	7244	Roller Clutch Reinforce	7537	Pinion Gear
6018	Ball Bearing	7461	Nut Lock Screw	7538	Drive Gear
6035	Line Roller	7463	Line Roller Washer	7539	Side Cover
6040	Roller Clutch Assembly	7464	Bail Spring Guide (A)	7540	Side Cover Flange
6042	Friction Ring	7465	Bail Spring Guide (B)	7541	Anti-Reverse Lever
6044	Anti-Reverse Cam Spring	7466	Click Pin	7542	Body
6049	Bushing	7467	Click Spring	7543	Roller Clutch Screw
6055	Rear Protector Screw	7469	Line Roller Screw		
6057	Cap Screw	7470	Bail Arm Screw		